

MSBA Process



GIENAPP
ARCHITECTS
Begin Here. Finish Well.

August 22, 2022

MSBA Process—Current Module Tasks

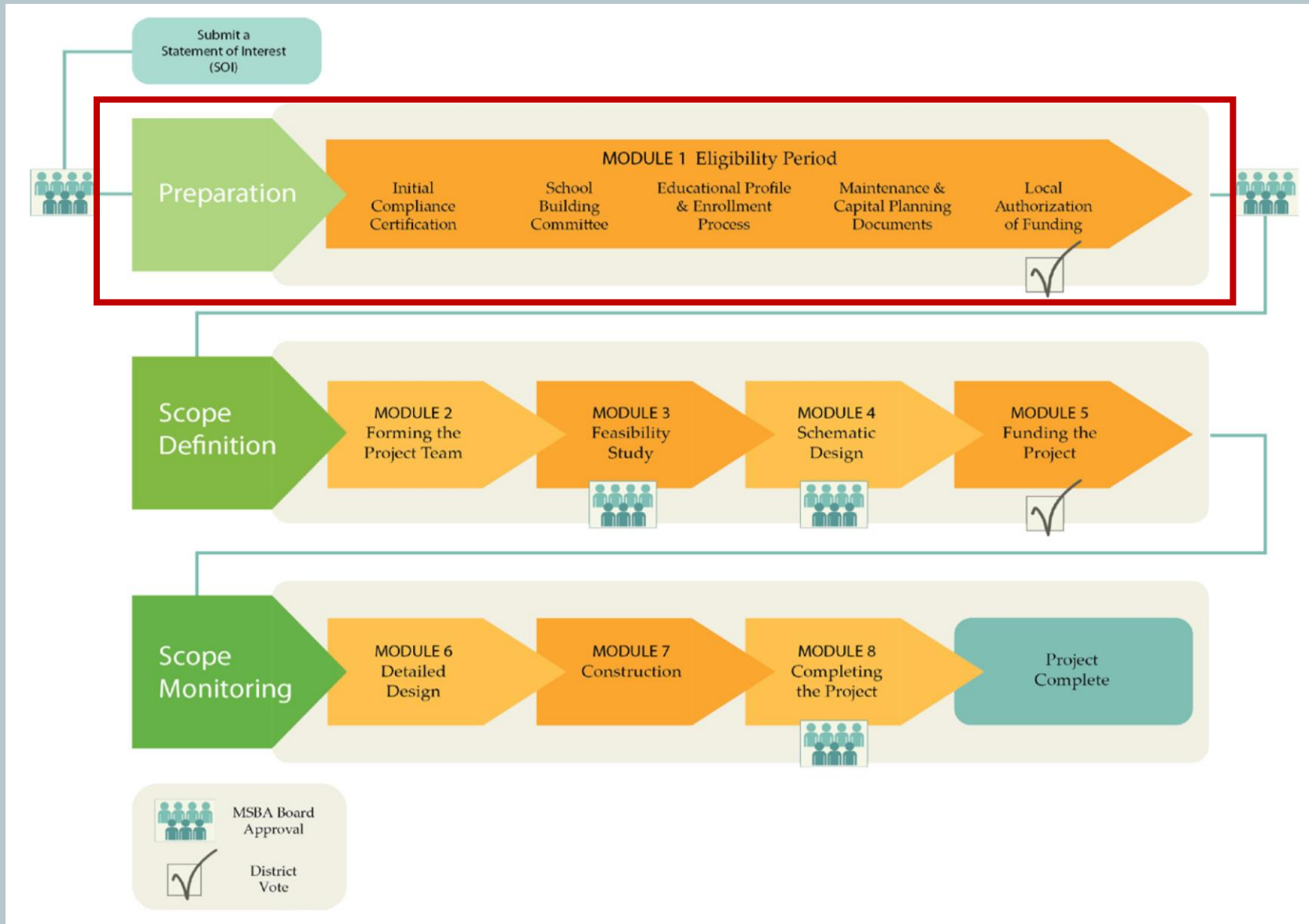

Implementation Plan—Eligibility Period

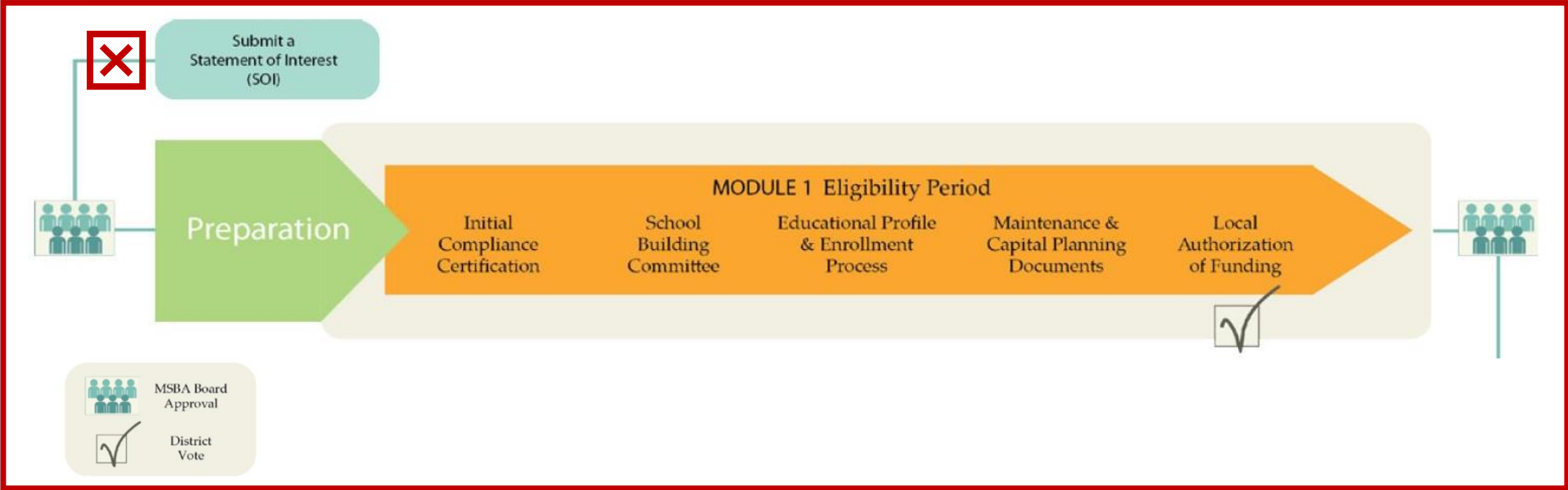

Prospective Timeline

- Eligibility Period/Preparation 270 days
Jun 1 – Feb 26, 2023
12 Weeks Elapsed 28 Weeks Remaining

- Project Team (OPM, Designer) 150 days
- Feasibility Study 300 days
- Schematic Design 75 days
- Project Scope & Funding 90 days
- Final Design 1 year
- Construction 1.5 years

Total= 3.5 years

*The above are maximum allowed durations. Many steps will likely overlap, resulting in a shorter, 3.5-year timeframe.

To-Do List

<u>Task</u>	<u>Who is responsible?</u>
<input type="checkbox"/> Complete Initial Compliance Certification (Collaboration Contract).....	CEO; Superintendent; Chair of School Committee
<input type="checkbox"/> Appropriate Money.....	Town Manager; Town Meeting
<input checked="" type="checkbox"/> Appoint Building Committee.....	Town Manager, ???
<input type="checkbox"/> MSBA Approval of Building Committee.....	MSBA
<input type="checkbox"/> Fund OPM, Feasibility through Schematic.....	Town Meeting
<input type="checkbox"/> Fund Designer, Feasibility through Schematic.....	Town Meeting
<input type="checkbox"/> Compile Maintenance & Capital Planning Documents.....	Facilities Dept; RPS Office; Business Office; School Committee
<input type="checkbox"/> Summary of Maintenance Practices.....	Facilities Dept; RPS Office; Business Office; School Committee
<input type="checkbox"/> Complete Educational Profile Questionnaire.....	RPS; School Committee
<input type="checkbox"/> Refine Enrollment Process & Data.....	RPS; School Committee
<input type="checkbox"/> Town Meeting Warrant Articles (timely).....	Town Manager; Select Board
<input type="checkbox"/> Confirm Community Vote Authorization.....	???

Potential Cost—Designer & OPM Fees

Appropriation in Module 1 for Module 2

District	Enrollment	GSF (K)	Year	DESIGNER			OPM	Estimating Contingency (20%)	Market Conditions Contingency (10%)	Feasibility Study Total	15% Esc.
				Feasibility Study	Reim. Services	Testing & Other*	Feasibility Study				
						Total (All)					
Groton-Dunstable	645	109,856	2022	\$526,550	\$5,500	\$392,650	\$223,450	\$229,630	\$137,778	\$1.5 M	\$1.7M
Ashland	635	104,885	2021	\$740,000	\$20,000	\$515,000	\$260,000	\$307,000	\$184,200	\$2.0M	\$2.3M
Bridgewater-Raynham	740	132,045	2021	\$565,000		\$210,000	\$235,000	\$202,000	\$121,200	\$1.3M	\$1.5M
Ludlow	630	106,250	2019	\$681,295	\$40,000	\$125,000	\$200,813	\$209,422	\$125,653	\$1.4M	\$1.6M
Taunton	735	119,693	2019	\$1,099,890	\$10,000	\$225,000	\$240,182	\$315,014	\$189,009	\$2.1M	\$2.4M

*Testing & Other is Hazardous Materials, Geotech, Site Survey, Wetlands, and Traffic Study

Implementation Plan—Next After Module 1 After February 2023

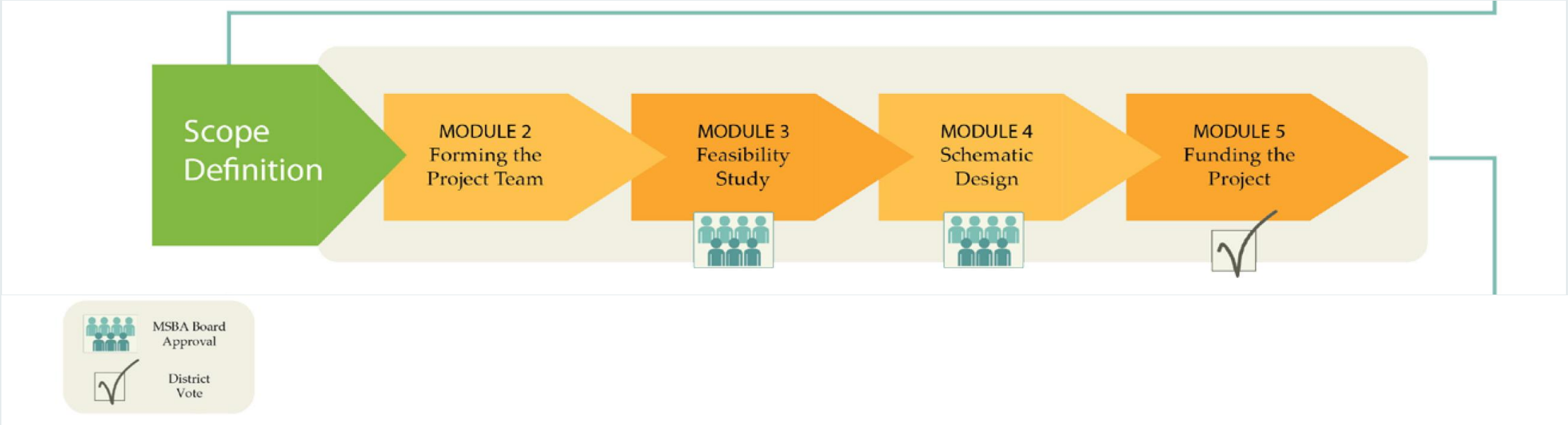

Module 2—Forming the Project Team



OPM

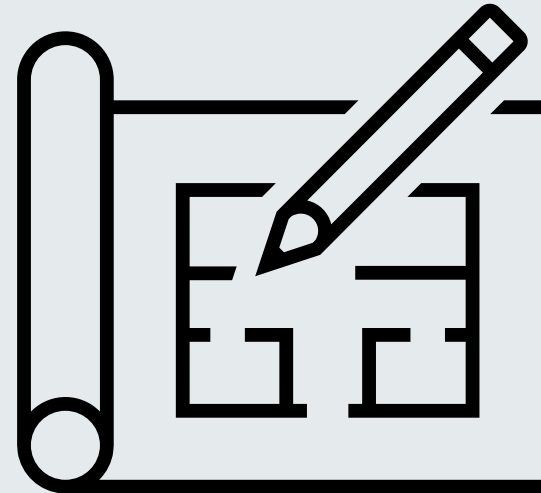

Architect

Module 3—Feasibility Study



**Preliminary Design
Program**

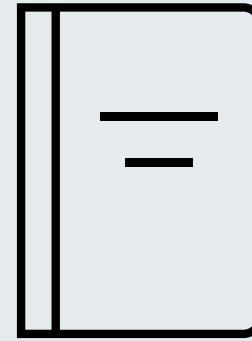

**Preferred Schematic
Report**

- Document educational program
- Generate an initial space summary
- Document existing conditions
- Establish design parameters
- Develop and evaluate alternatives
- Recommend the most cost effective and educationally appropriate preferred solution to the MSBA Board of Directors for their consideration.

Module 4—Schematic Design



- The District and its team develop a final design program and robust schematic design of sufficient detail to establish:

- Scope
- Budget
- Schedule

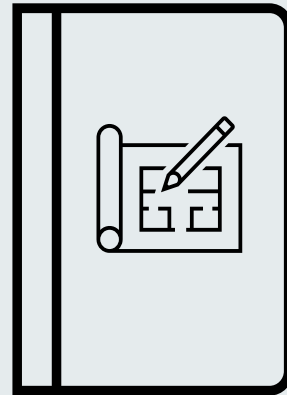

**Schematic Design
Report**

Module 5—Project Scope & Budget & Project Funding Agreements

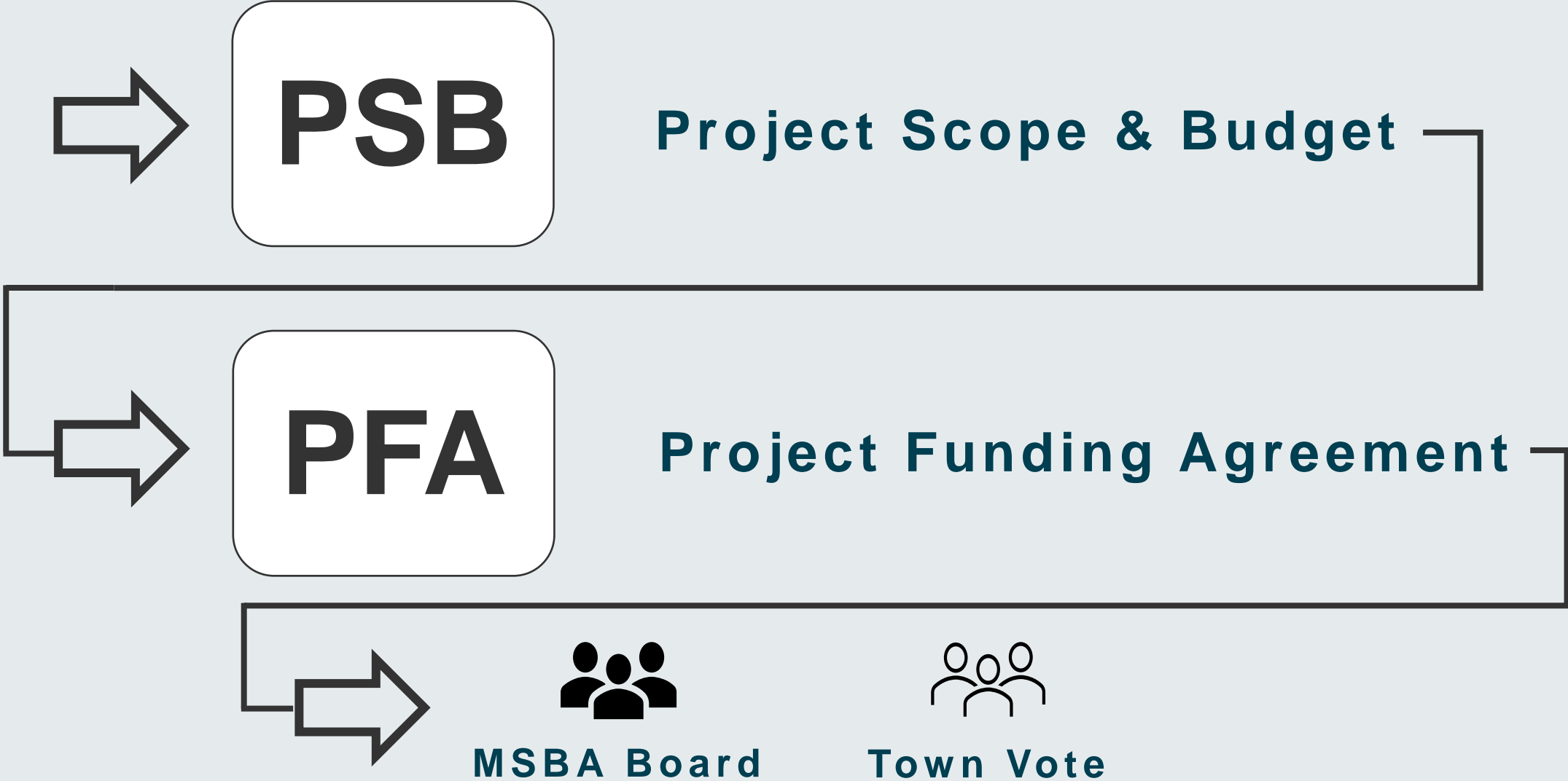

CONTACT US



Gienapp Architects
Dale Gienapp, AIA, MCPPO
20 Conant Street, Danvers, MA 01923

978-750-9062

dgienapp@GienappArchitects.com

GienappArchitects.com



MSBA Requirements for School Building Committee Membership



- A member who is MCPPO certified
- Chief Financial Officer
- Town Manager
- Minimum of one School Committee member
- Superintendent of Schools
- Director of Facilities
- Representative of Office authorized by law to construct school buildings
- School Principal
- Member knowledgeable in educational mission and function of facility
- Local budget official or member of local Finance Committee
- Members of community with architecture, engineering and/or construction experience (Permanent Building Committee members)
- Other